

Overview

- 4MP IR
- True WDR 120dB
- 4.0mm lens
- H.265
- IP67, IK10 rated





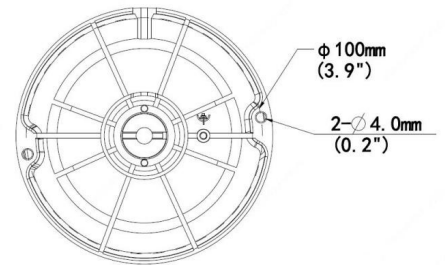
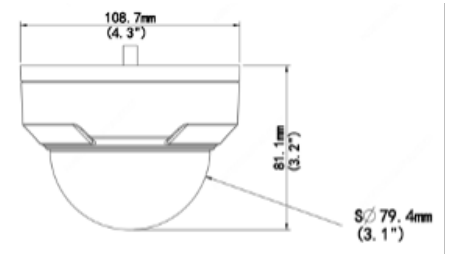

Technical Specifications

Device	
Image Sensor:	1/2.7", 5.0 Megapixel, Progressive Scan, CMOS
Min Illumination:	Color: 0.003Lux (F1.6, AGC ON) 0Lux with IR
Shutter Time:	Auto/Manual, 1 ~ 1/100000s
Lens:	4.0mm@F1.6
WDR:	120dB
Angle of View:	H: 91.2°, V: 47.9°, O: 95.9°
Angle Adjustment:	Pan: 8° ~ 360° Tilt: 0° ~ 68° Rotate: 10° ~ 360°
3-Axis Adjustment:	Yes
Day & Night:	IR-Cut Filter with Auto Switch (ICR)
IR Range:	Up to 30m (98ft) IR range
Compression Standard	
Video Compression:	Ultra 265, H.265, H.264, MJPEG
Video Bit Rate:	128 Kbps~16 Mbps
Dual Streams:	Yes
Analytics:	Cross line, Intrusion, Human Body Detection, Motion Detection, Tampering Alarm, Audio Detection
Image	
Max. Image Resolution:	2688 x 1520
Frame Rate:	25fps (2688 x 1520)
ROI Codec:	Up to 8 Areas
Image Setting:	White Balance, Image Setting, Digital Noise Reduction, Smart IR, Flip, HLC, BLC, Defog



Technical Specifications

Network		
Alarm Channels:	N/A	
Protocols:	IPv4, IGMP, ICMP, ARP, TCP, UDP, DHCP, RTP, RTSP, RTCP, RTMP, DNS, DDNS, NTP, FTP, UPnP, HTTP, HTTPS, SMTP, SSL/TLS, 802.1x, SNMP	
Interface		
Communication Interface:	1 RJ45 10M/100M Base-TX Ethernet	
Local Storage:	Micro SD, up to 256GB	
Audio:	Built-in Mic	
General		
Safety	CE: EN 60950-1, UL: UL60950-1, IEC 60950-1	
EMC	FCC: FCC Part15	
Operating Conditions:	Temperature: -30°C ~ 60°C (-22°F ~ 140°F), Humidity: ≤95% RH (Non-Condensing)	
Power Consumption:	Max 4.5W	
Power Supply:	DC 12V±25%, PoE (IEEE 802.3af)	
Weather Proof Rating:	IP67	
Vandal Resistant:	IK10	
Dimensions:	Φ109 x 83mm (Ø4.3" x 3.3")	
Weight:	0.36kg (0.79lb)	
Software:	Includes Video Insight VMS License	
Accessories		
M-JB-MINI	M-WM-JB-MINI	M-PM
		
M-Pendant-Ex	M-Pendant	
		

R071222 | Product specifications and availability are subject to change without notice.

© i-PRO Co., Ltd. All Rights Reserved. i-PRO, Viewnetcam.com, Advidia, VideoInsight, CloUDE, and Unified Digital Evidence are registered trademarks or trademarks of i-PRO Co., Ltd. or i-PRO Americas Inc. in various jurisdictions. All other trademarks are the property of their respective owners.