



## 1CH H.264 Real-time Network Video Encoder

### Key Features

- Full frame H.264 transmission
- H.264 and JPEG triple encoding: A total of 3 outputs, comprising of 2 H.264 outputs and 1 JPEG output, can be provided.
- Motion adaptive interlace/progressive conversion allows every frame to be clear even when the subject is moving.
- Open command conversion table for RS485 ensures the control of various manufacture's PTZ camera.
- Camera title display: Up to 20 alphanumeric characters embedded in the image
- PoE. The power will be supplied by simply connecting a LAN cable. (IEEE802.3af compliant) 12 V DC power supply\* is also available.
- Small size. And can be installed into the outdoor housing with a camera.
- Alarm sources including VMD, Command alarm, and Video loss
- VMD (Video Motion Detector) with 4 programmable detection areas
- Internet mode: H.264 images can be transmitted by over HTTP protocol.
- Multi-language GUI and setup menu: English, French, Italian, Spanish, German, Russian, Chinese, Japanese

- IPv4/IPv6 protocol supported
- ONVIF® compliant model
- \* For UL listed model(s), only connect 12 V DC Class 2 power supply.

### Standard Accessories

• Installation Guide.....	1 pc.
• CD-ROM*1 .....	1 pc.
• Code label*2.....	1 pc.
• Power cord plug.....	1 pc.
• Cable tie .....	2 pcs. (incl. 1 spare)

\*1 The CD-ROM contains the operating instructions and different kinds of tool software programs.  
\*2 This label may be required for network management. The network administrator shall retain the code label.

## Specifications

TV System		NTSC	PAL
<b>Video IF</b>	Video Input Connector	1 V [p-p]/75 Ω, NTSC or PAL composite video signal* * NTSC and PAL can be switched in the setup menu.	
<b>Browser GUI</b>	Camera Control	pan / tilt / zoom / focus / preset positions / auto focus / brightness	
	Camera Control Protocol	i-PRO (Panasonic) / Pelco-D / Pelco-P / Custom	
	Display Mode	Up to 16 camera images can be displayed simultaneously on a multi-screen. (Including the camera itself)	
	Unit Title	Up to 20 characters	
	Camera Title (OSD)	Up to 20 characters (alphanumeric characters, marks) On/Off	
	Clock Display	Time: 12H/24H, Date: 5 formats on the browser. Summer time (Auto / Manual)	
	Alarm Control	Reset	
	GUI/Setup Menu Language	English, French, Italian, Spanish, German, Russian, Chinese, Japanese	
	System Log	Up to 100 (Internal)	
	Supported OS <sup>1,2</sup>	Microsoft® Windows® 7 Microsoft® Windows Vista® Microsoft® Windows® XP Professional SP3	
Supported Browser	Windows® Internet Explorer® 9.0 32 bit Windows® Internet Explorer® 8.0 32 bit Windows® Internet Explorer® 7.0 32 bit Internet Explorer® 6.0 SP3		
<b>Network</b>	Network IF	10Base-T / 100Base-TX, RJ-45 connector	
Image Resolution	Picture (Camera) mode [4:3]	H.264: VGA (640x480)/QVGA (320x240), max. 30 fps JPEG: VGA (640x480)/QVGA (320x240), max. 30 fps	H.264: VGA (640x480)/QVGA (320x240), max. 25 fps JPEG: VGA (640x480)/QVGA (320x240), max. 25 fps
	Picture (Camera) mode [16:9]	H.264: 640x360/320x180, max. 30 fps JPEG: 640x360/320x180, max. 30 fps	H.264: 640x360/320x180, max. 25 fps JPEG: 640x360/320x180, max. 25 fps
H.264 <sup>3</sup>	Picture (Camera) mode [D1]	H.264: D1 (720x480), max. 30 fps JPEG: D1 (720x480), max. 30 fps	H.264: D1 (720x576), max. 25 fps JPEG: D1 (720x576), max. 25 fps
	Transmission Mode	Constant bitrate / Framerate priority / Best effort	
	Frame Rate	1 / 3 / 5 / 7.5 / 10 / 15 / 20 / 30 fps	
	Bit Rate/Client	64 / 128 / 256 / 384 / 512 / 768 / 1,024 / 1,536 / 2,048 / 3,072 / 4,096 kbps	
	Image Quality	Low / Normal / Fine	
JPEG	Refresh Interval	0.2 / 0.25 / 0.33 / 0.5 / 1 / 2 / 3 / 4 / 5 s	
	Transmission Type	Unicast / Multicast	
JPEG	Image Quality	10 steps	
	Refresh Interval	0.1 fps ~ 30 fps (JPEG frame rate will be restricted when displaying both JPEG and H.264 images.)	0.08 fps ~ 25 fps (JPEG frame rate will be restricted when displaying both JPEG and H.264 images.)
Total Bit Rate	Transmission Type	Pull / Push	
	Supported Protocol	64 / 128 / 256 / 384 / 512 / 768 / 1,024 / 2,048 / 4,096 / 8,192 kbps / Unlimited	
FTP Client	Supported Protocol	IPv6: TCP/IP, UDP/IP, HTTP, HTTPS, RTP, FTP, SMTP, DNS, NTP, SNMP, DHCPv6, MLD, ICMPv6 IPv4: TCP/IP, UDP/IP, HTTP, HTTPS, RTSP, RTP, RTP/RTCP, FTP, SMTP, DHCP, DNS, DDNS, NTP, SNMP, UPnP, IGMP, ICMP, ARP	
	No. of Simultaneous Users	Alarm image FTP transmission, FTP periodic image transmission <sup>4</sup> Up to 14 users. (Depends on network conditions)	
Alarm	Cellular Phone Compatibility	JPEG image	
	Mobile Terminal Compatibility <sup>5</sup>	iPad, iPhone, iPod touch (iOS 4.2.1 or later), Android™ mobile terminals	
Input/Output General	Alarm Source	VMD, Command alarm, Video loss alarm	
	Alarm Actions	E-mail notification Indication on browser, FTP image transfer, TCP alarm notification output	
Safety/EMC Standard	RS485 Port	1x RS485 (4 wire / 2 wire, Full/Half duplex). Open command conversion table for other manufacturers' PTZ camera)	
	Power Source and Power Consumption	UL (UL60950-1), FCC (Part15 ClassA), C-UL (CAN/CSA C22.2 No.60950-1), DOC (ICES003 ClassA)	CE (EN55022 ClassB, EN55024)
Ambient Operating Temperature	UL (UL60950-1), FCC (Part15 ClassA), C-UL (CAN/CSA C22.2 No.60950-1), DOC (ICES003 ClassA)	12 V DC*: 200 mA, PoE 48 V: 75 mA (Class 1 device) * For UL listed model(s), only connect 12 V DC Class 2 power supply.	
	Ambient Operating Humidity	-10 °C ~ +50 °C (14 °F ~ 122 °F) (During start-up: 0 °C to +50 °C (32 °F to 122 °F))	
Dimensions	Less than 90 % (no condensation)	45 mm (W) x 29.5 mm (H) x 88 mm (D) (1-25/32 inches (W) x 1-5/32 inches (H) x 3-15/32 inches (D)) (excluding projections)	
	Mass (approx.)	Approx. 110 g (0.24 lbs)	
Finish	Unit (resin part): PC resin, sail white	Unit (metal part): Electrogalvanized steel sheet, sail white coating	

\*1 For further information about PC system requirements and precautions for when using Microsoft® Windows® 7, Microsoft® Windows Vista®, or Windows® Internet Explorer®, click "Manual" - "Open" from the supplied CD-ROM and refer to "Notes on Windows®/Internet Explorer® versions".  
\*2 When using IPv6 for communication, use Microsoft® Windows® 7 or Microsoft® Windows Vista®.  
\*3 Transmission for 2 streams can be individually set in the same compression method.  
\*4 Not available when "D1" is selected for "Picture (Camera) mode".  
\*5 For further information about compatible devices, refer to our website (<https://i-pro.com/global/en/surveillance/training-support/support>).

### Trademarks and registered trademarks

- Microsoft, and Windows are registered trademarks of Microsoft Corporation in the U.S. and other countries.
- iPad and iPhone are trademarks of Apple Inc., registered in the U.S. and other countries.
- Android is a trademark of Google LLC.
- ONVIF is a trademark of ONVIF, Inc.
- All other trademarks identified herein are the property of their respective owners.

### Important

- Safety Precautions : Carefully read the Basic Information, Installation Guide and Operating Instructions before using this product.
- i-PRO Co., Ltd. cannot be held responsible for the performance of the network and/or other manufacturers' products used on the network.

- Masses and dimensions are approximate.
- Specifications are subject to change without notice.
- These products may be subject to export control regulations.

## Part Names and Functions

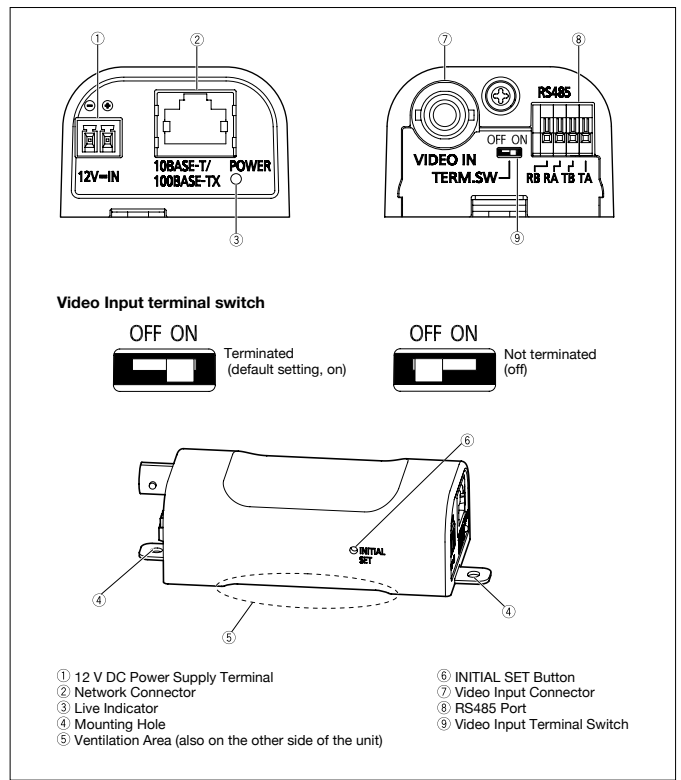

## Appearance

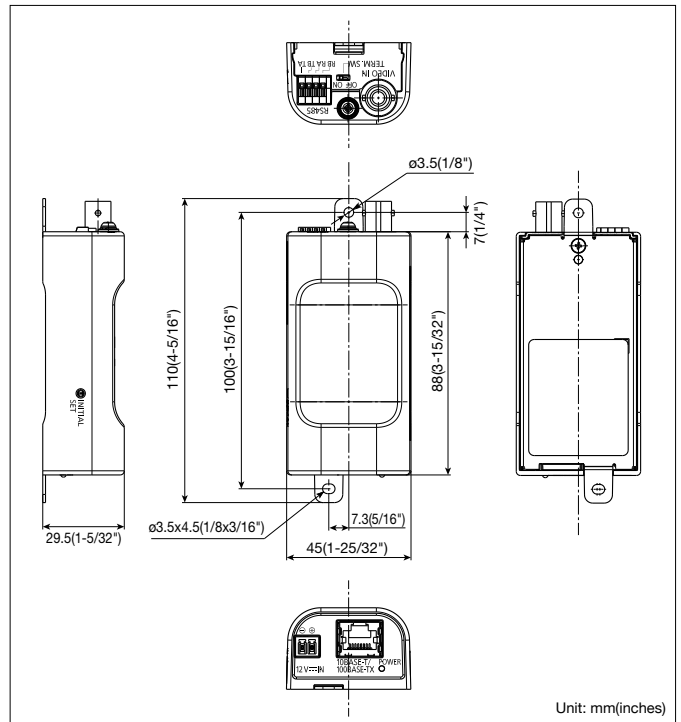

**i-PRO**  
The Power of Truth

i-PRO Co., Ltd.

<https://i-pro.com/>

(2A-104BA)