

No.	品名	Part Name	Material	Process · Remark
1	サンシェード	Sun Shade	Aluminium die cast	Coating (i-PRO white)
2	ベースカバー	Base Cover Option	Stainless Steel	-
3	M4 トルクスネジ	Torx screw M4	Stainless Steel	-
4	主銘版	Name Plate	Polyester Film	Printing
5	シリアルNo.ラベル	Serial No. Label	Polyester Film	Printing

CONNECT TO WV-S2531L

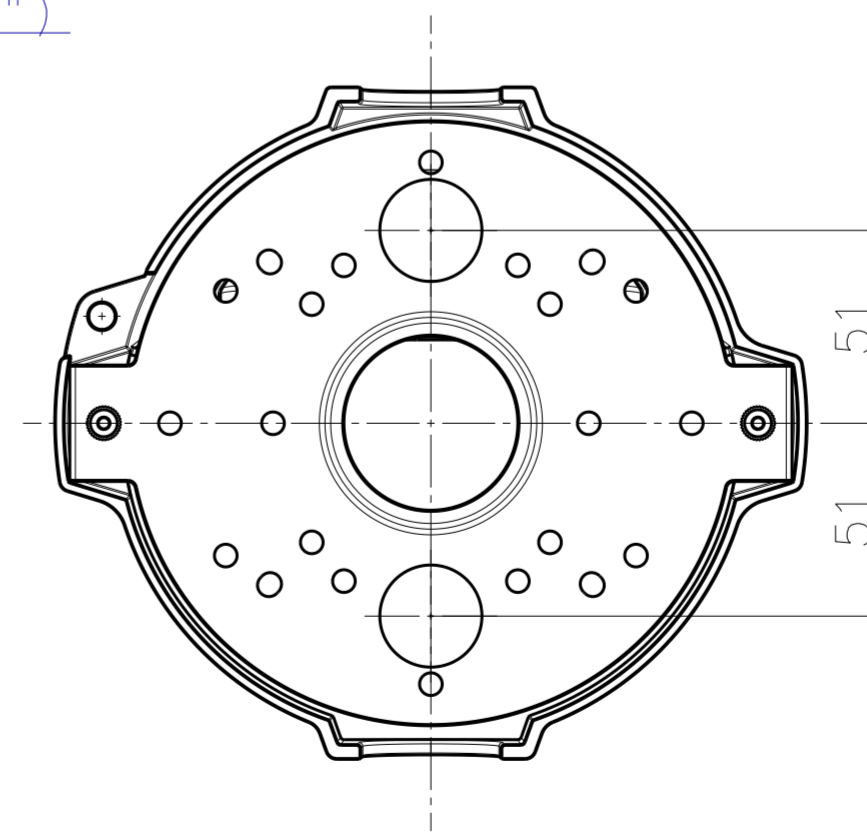
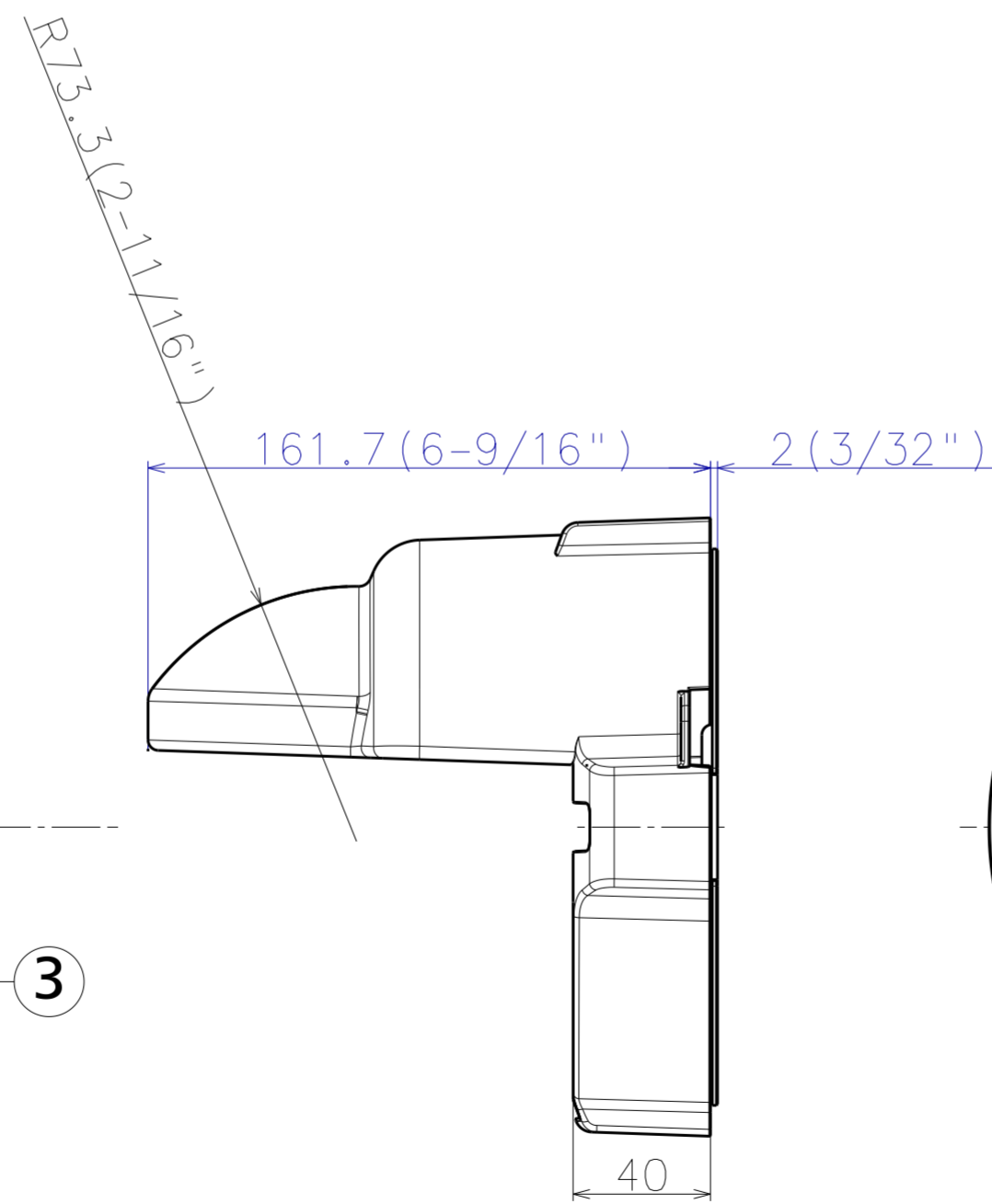
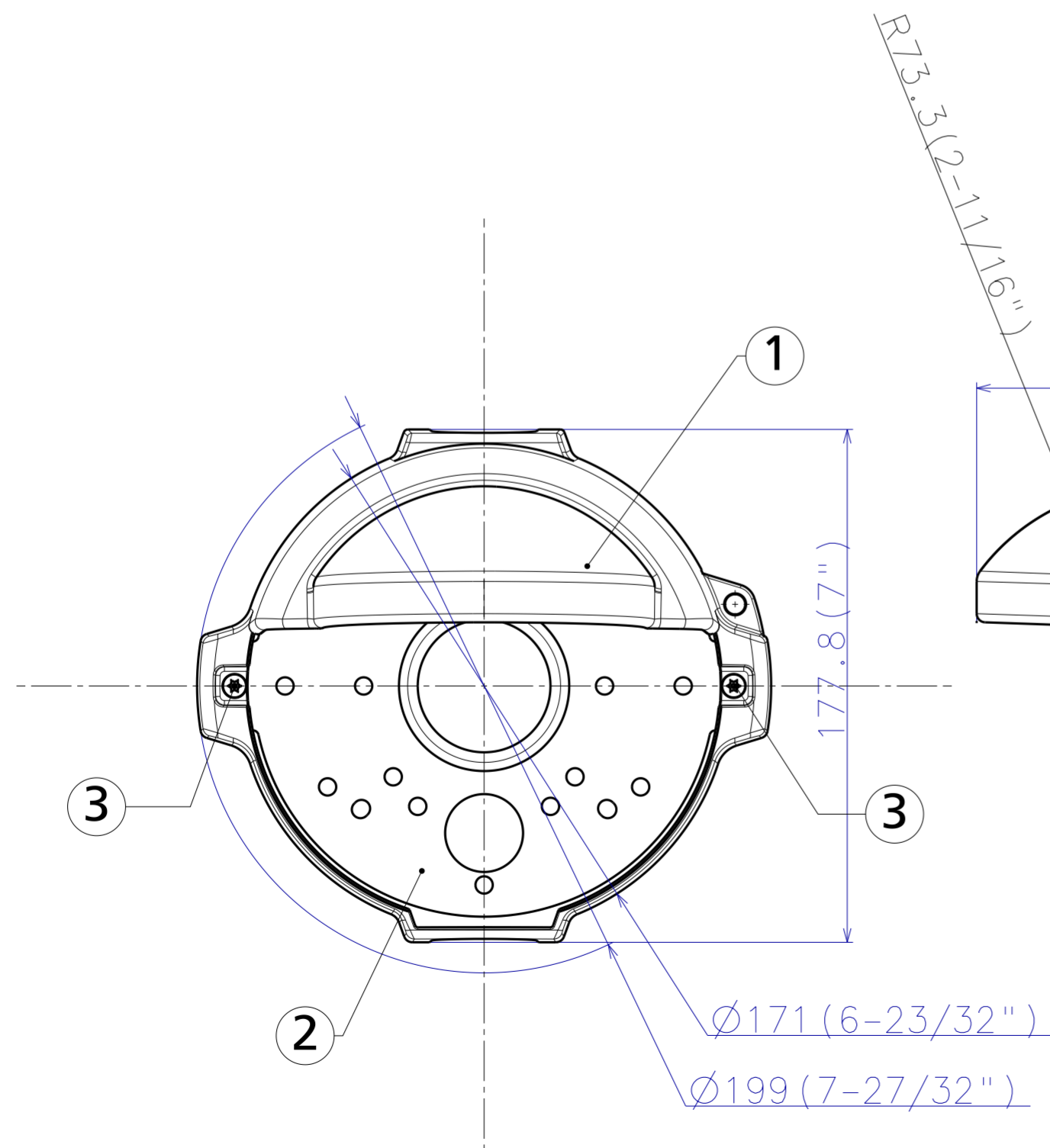
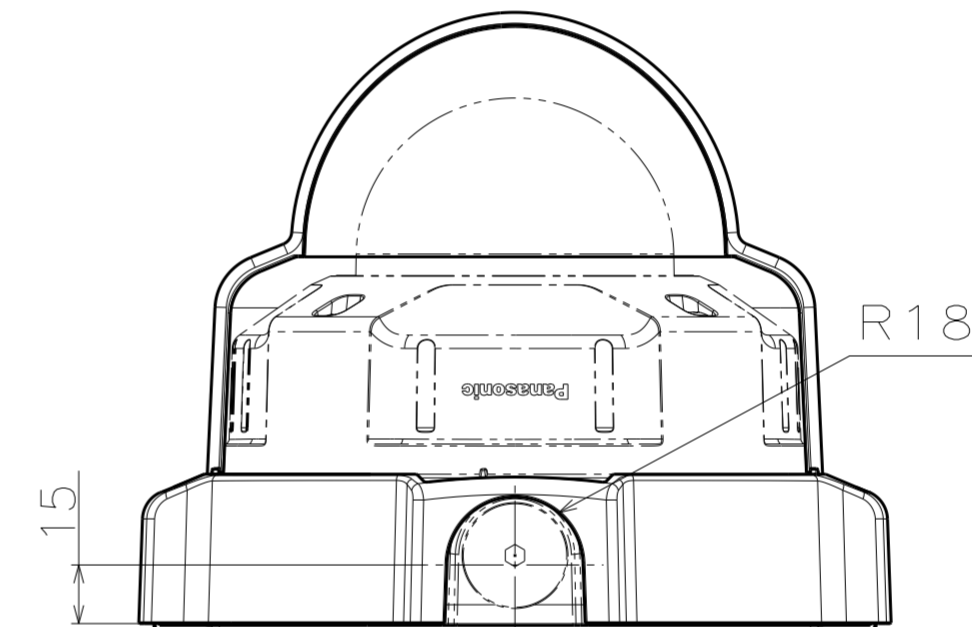
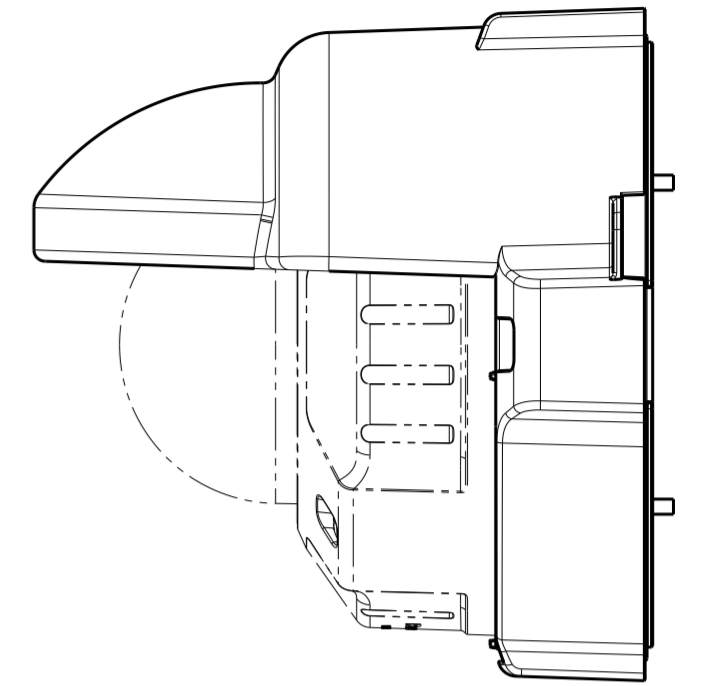
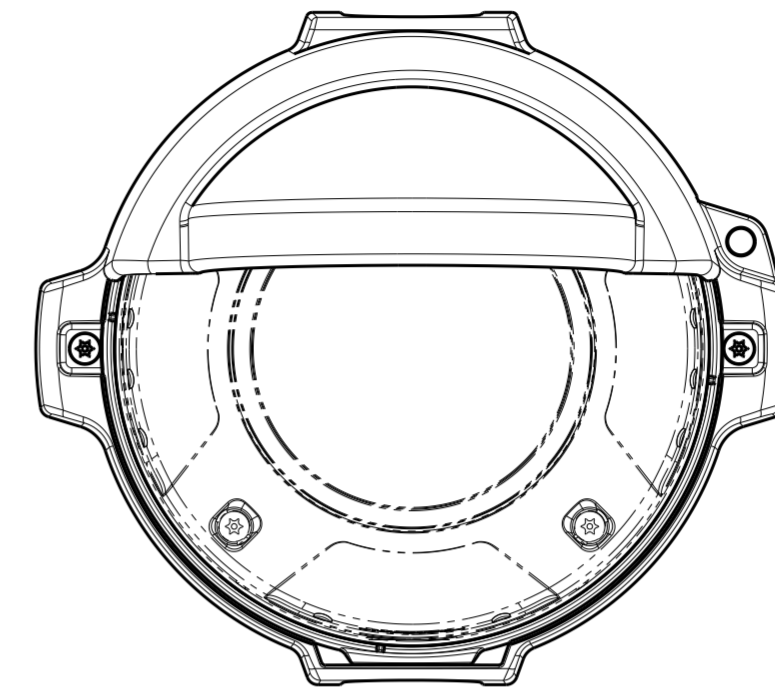
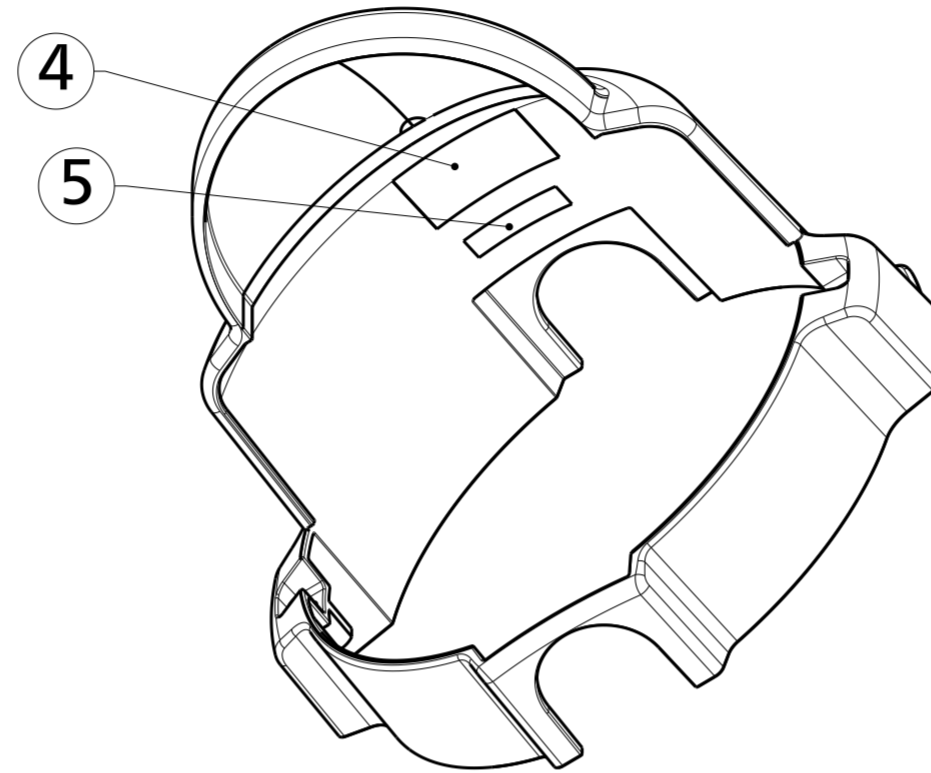
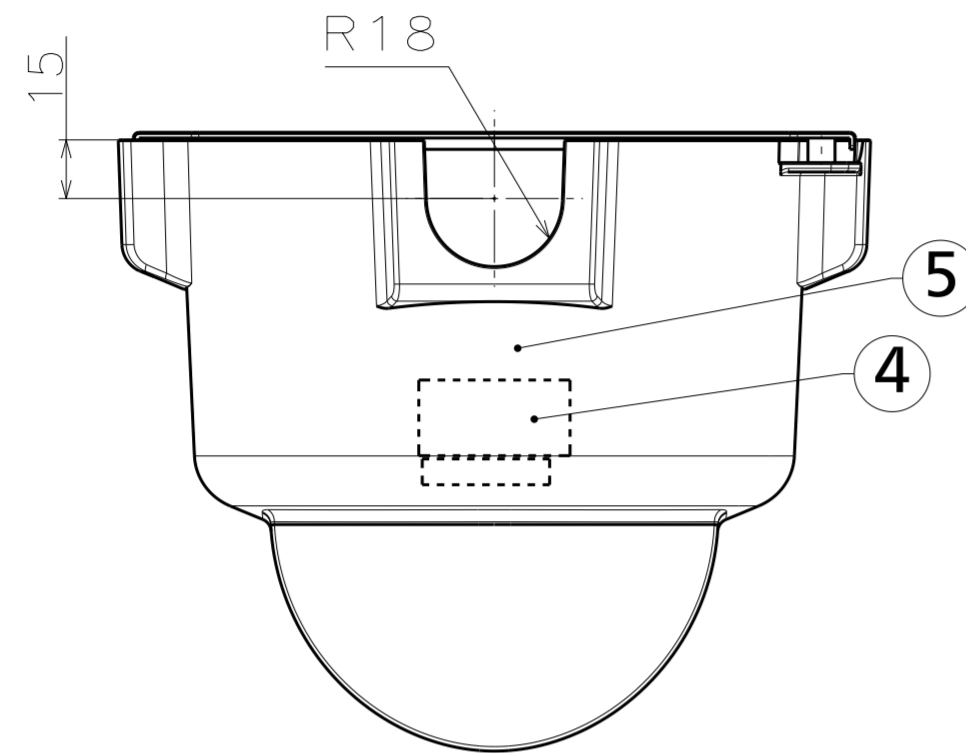

	投影面積 (Projected area)
側面図/Side-view	0.021 m ²
平面図/Top-view	0.023 m ²

注) WV-S2531Lを含む
Note) Include WV-S2531L

	投影面積 (Projected area)
側面図/Side-view	0.013 m ²
平面図/Top-view	0.023 m ²

Weight : Approx. 540 g {0.73 lbs}

WV-QSR500-W(WV-QSR500-WUYS)

取り付けに使用する穴について

Regarding to the Holes are used for mounting.

天井や壁面の状態によって次の6通りのねじ位置で固定できます。(使用ねじ M4)

It is fixable according to the state of a ceiling or the surface of a wall in six kinds of screw positions as follows. (Screw M4)

接続管を使って配線する場合は配線用の穴は不要です。

When wiring using a connecting pipe, the hole for wiring is unnecessary.

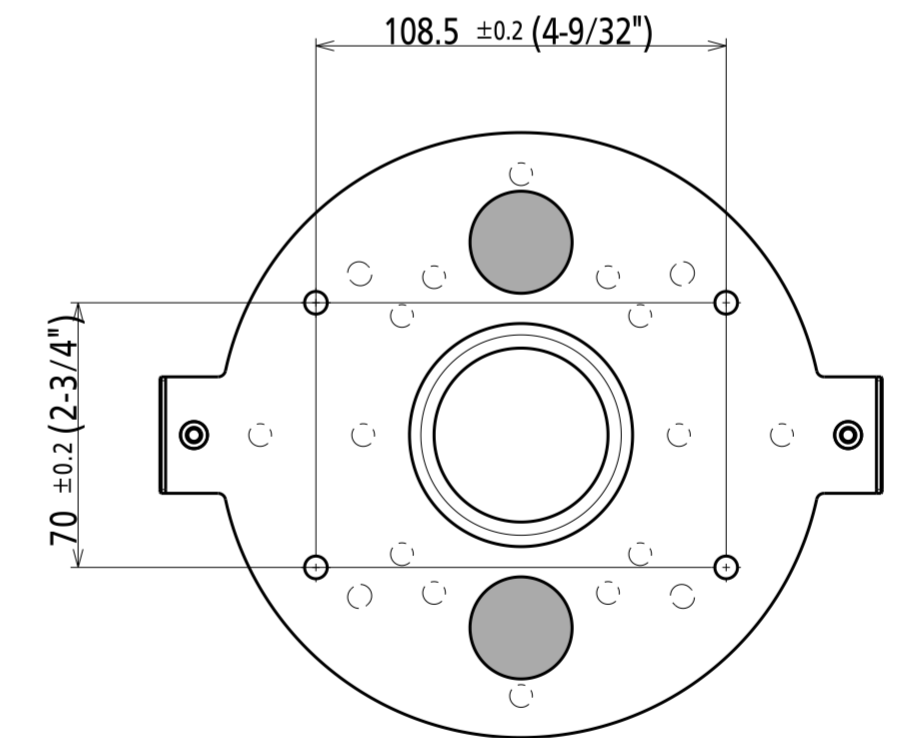
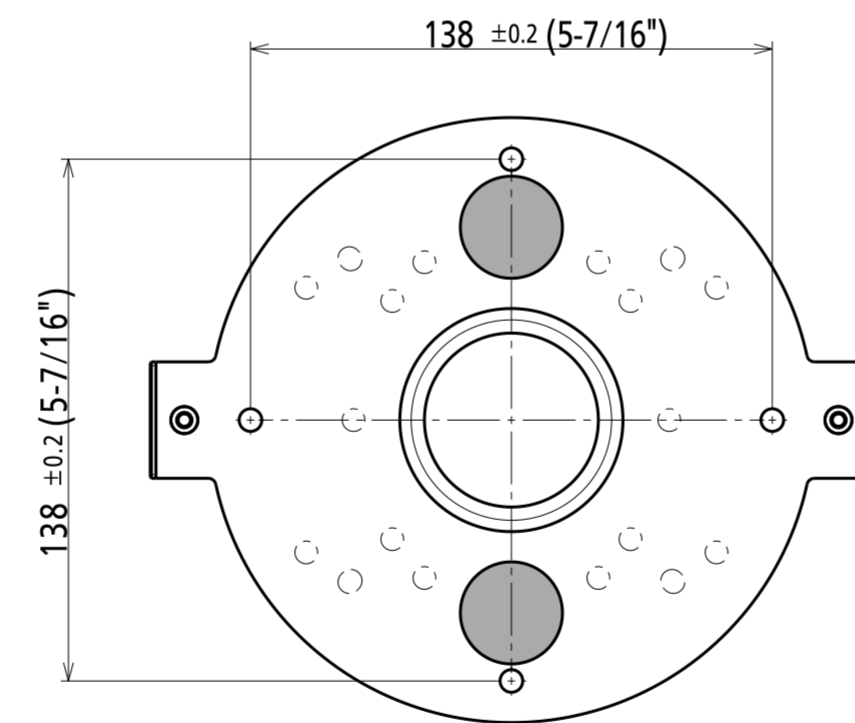
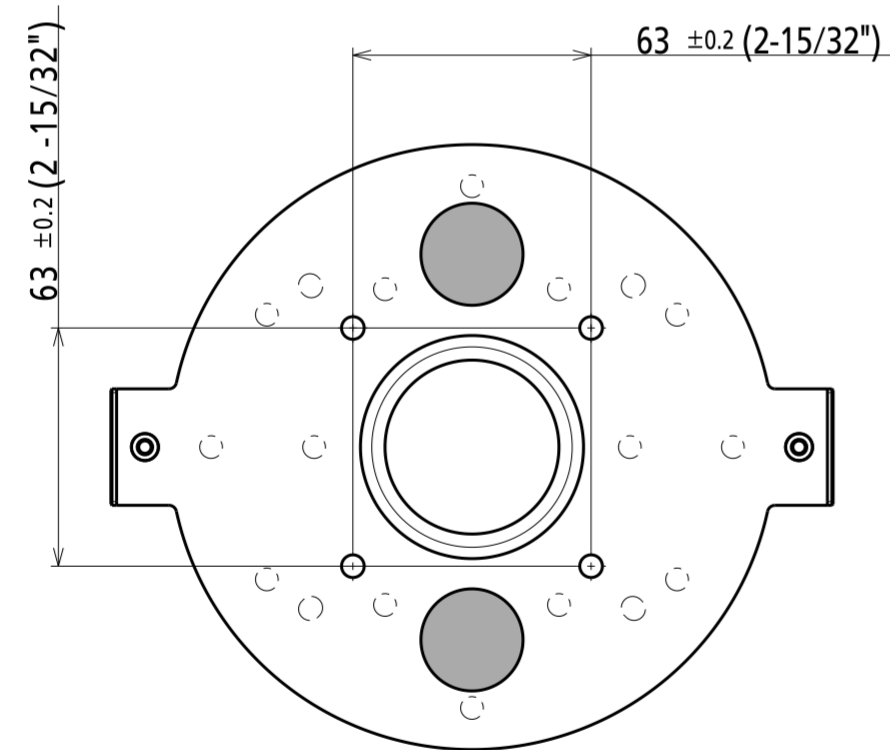
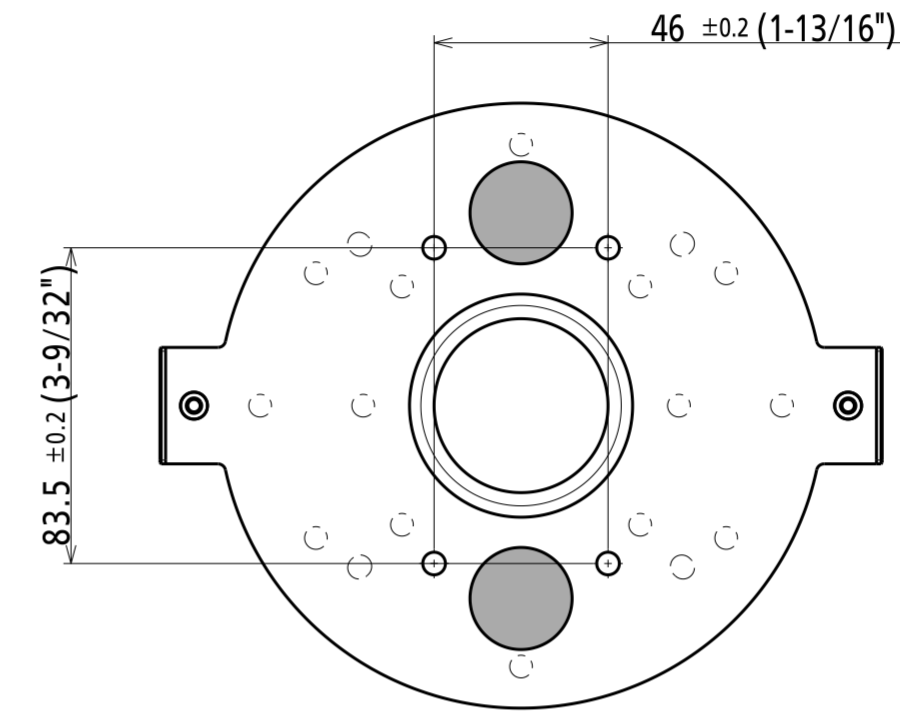
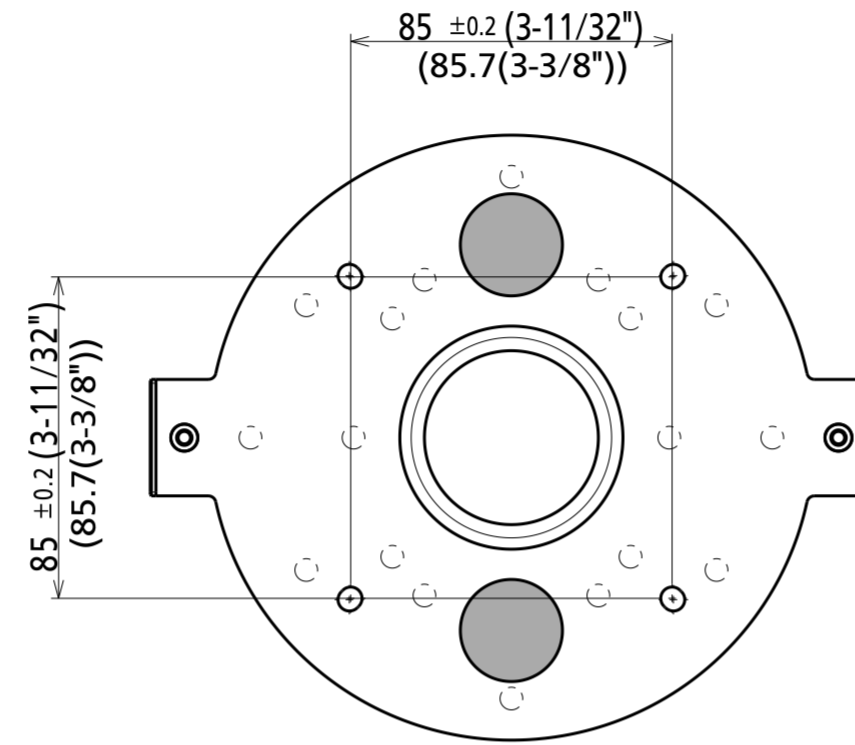
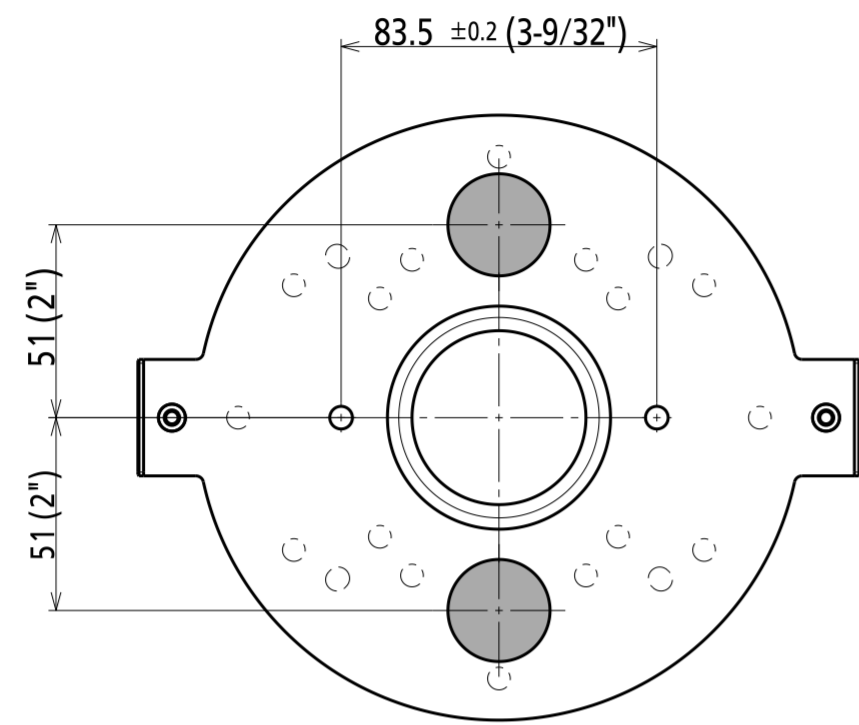

※図中のグレーの部分は配線用の穴です。2か所のどちらかを選んで $\phi 25.4$ mm (1 inch) の穴をあけてください。

* The portion of the gray in a figure is a hole for wiring.

Please choose one of two places and make a $\phi 25.4$ mm hole.